



CMAlifts®

C.M.A. S.r.l. | S.P. 238 km. 11,728 - 70033 Corato (BA) - Italy
TEL. +39 080.3588714 - FAX +39 080.8729113
INFO@CMALIFTS.COM - INFO@PEC.CMALIFTS.COM
CMALIFTS.COM



Marcatura CE delle strutture metalliche secondo la EN 1090-1:2009+A1:2011 con FPC 0476-CPR-0029

OFFER

ORDER

CLIENT _____

Ref. Lift/System _____

No. Lift/System _____

Ref. Plant _____

FOLDING DOORS ORDER FORM

PLEASE NOTE: tick the box of the chosen car frame model, indicating the performance requirements as well. Enclose with this form a copy of your project; please write the measurements in mm.

No. folding doors Opening X Free passageway

All standard folding doors have the threshold flush to the floor. In specific cases please contact CMA sales office.

OPERATOR

- Motor 24 V cc
- Motor 48 V cc
- Motor 1215 V ca
- Motor 220 V ca

STEEL VESTMENT FOR SAFETY LANDING

- Height 120
- Height 750

OPTIONAL - Lateral Jamb Supply

- anodised aluminium Colour _____
- satin stainless steel

LANDING DOORS LOCK RELEASE CONTROL UNIT

H =

DOOR PANEL FINISHING

- Painting RAL Colour _____
- Natural anodised aluminium
- anodised aluminium Colour _____
- ScotchBrite steel
- Polished steel BA

HINGE FINISHING

- natural anodising
- anodised Colour _____

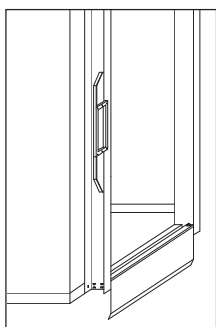
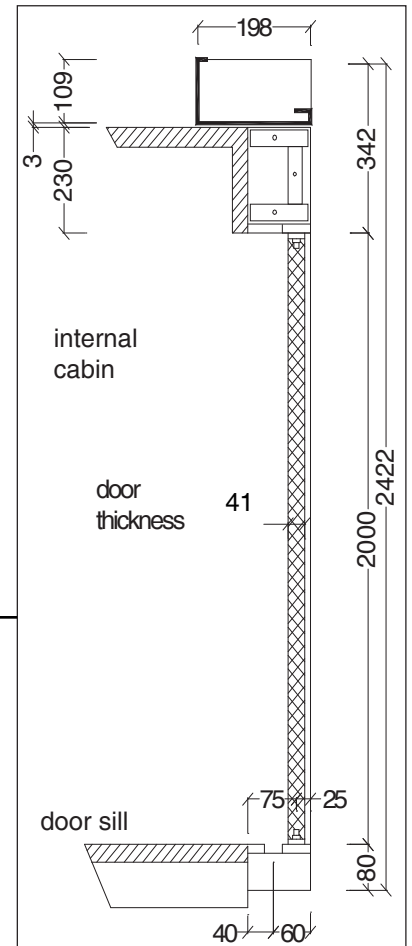

PARALLEL CAM

- Right
 - Left
- (seen from the floor)

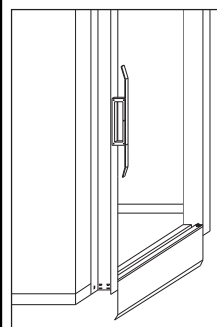

PERPENDICULAR CAM

- Right
 - Left
- (seen from the floor)

COMMERCIAL INFORMATION *cardboard packaging*

Delivery time _____

Delivery Address _____

Transport _____

Note _____

DATE _____

Stamp and signature for acceptance _____